

Scale 3/4 inch = 1 foot, and there before it was a man with a measuring line in his hand! Zerk, 2:1

SOIL CLASSIFICATION LEGEND

Soil Code	Description	Perc Rate (Predicted)
AuF	Ashier stony loamy sand, 25 to 45 percent slopes.	15
AuB	Ashier stony loamy sand, 45+ percent slopes.	15
Ce	Cartersville silt, frequently flooded.	20
GwC	Cartersville sandy loam, 6 to 10 percent slopes.	40
GwD	Cartersville sandy loam, 10 to 15 percent slopes.	40
GwE	Cartersville sandy loam, 15 to 25 percent slopes.	40
GwF	Cartersville sandy loam, 25 to 45 percent slopes.	40
McF	Muscogean cobbly loam, 25 to 45 percent slopes.	40
PaC	Pacolet sandy loam, 6 to 10 percent slopes.	30
PaD	Pacolet sandy loam, 10 to 15 percent slopes.	30
PaE	Pacolet sandy loam, 15 to 25 percent slopes.	30
PaF	Pacolet sandy loam, 25 to 45 percent slopes.	30

Soil Survey by Sidney M. Jones, Soil Scientist, NSCSS 019
 Reference report by Sidney M. Jones dated July 25, 1993
 Reference: Soil Survey of Forsyth County, Georgia; issued February 1960.
 Established Series National Cooperative Soil Survey U.S.A.

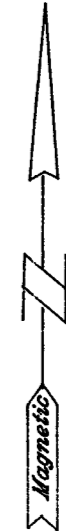
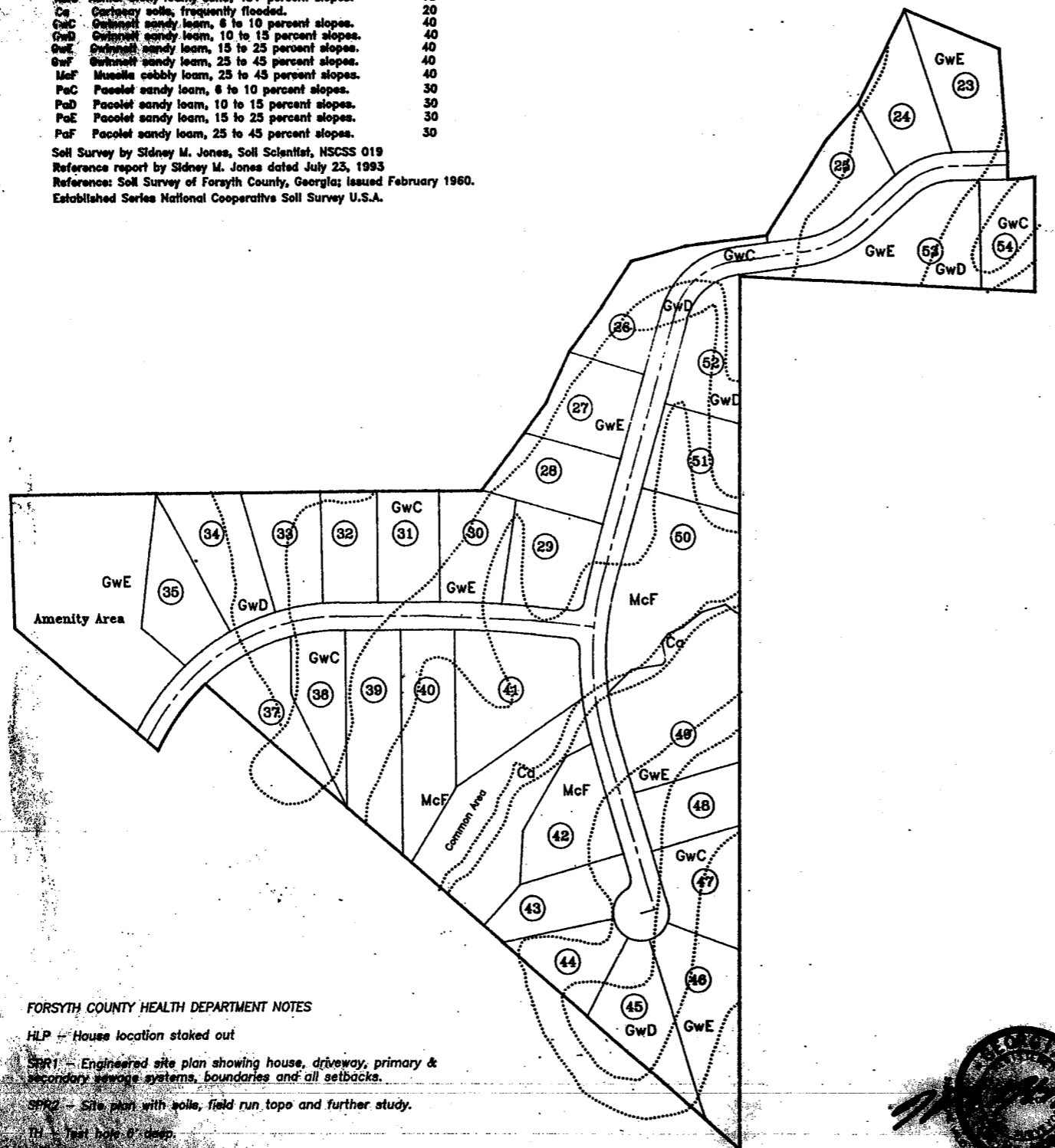

FINAL ** PLAT ** FOR
Cobblestone
 Phase Two

A Residential Subdivision
 Located in Land Lots 74, 75 & 162
 14th District *** 1st Section
 Forsyth County, Georgia
 February 13, 1995
 JOB 93205 * SF 93205F1 * CF 93205



APPALACHIAN SURVEY CO.

889-4691
 P.O. Box 1648
 Cumming, GA
 30130

FORSYTH COUNTY HEALTH DEPARTMENT NOTES
 HLP - House location staked out
 SPR1 - Engineered site plan showing house, driveway, primary & secondary sewage systems, boundaries and all setbacks.
 SPR2 - Site plan with soils, field run, topo and further study.
 TH - Test hole 6' deep.
 Further with coordinate placement of... Health Dept... will be made...



3-10-95
 3-10-95

