

| STATE | PROJECT NUMBER | SHEET NUMBER | TOTAL SHEETS |
|---------|----------------|--------------|--------------|
| GEORGIA | S-001832 | 8 | 24 |

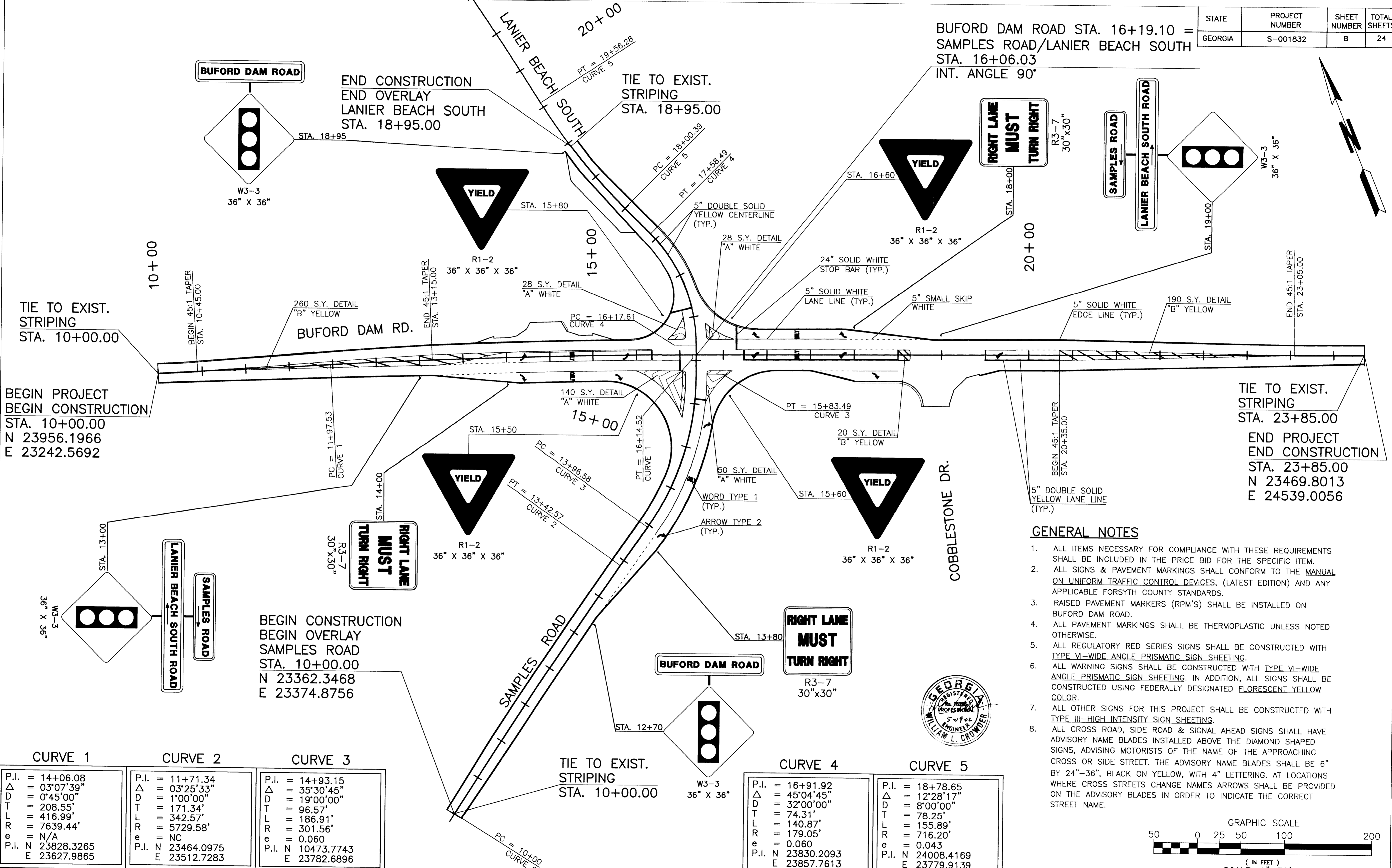

| CURVE 1 | CURVE 2 | CURVE 3 |
|-------------------|-------------------|-------------------|
| P.I. = 14+06.08 | P.I. = 11+71.34 | P.I. = 14+93.15 |
| Δ = 03°07'39" | Δ = 03°25'33" | Δ = 35°30'45" |
| D = 0°45'00" | D = 1°00'00" | D = 19°00'00" |
| T = 208.55' | T = 171.34' | T = 96.57' |
| L = 416.99' | L = 342.57' | L = 186.91' |
| R = 7639.44' | R = 5729.58' | R = 301.56' |
| e = N/A | e = NC | e = 0.060 |
| P.I. N 23828.3265 | P.I. N 23464.0975 | P.I. N 10473.7743 |
| E 23627.9865 | E 23512.7283 | E 23782.6896 |

| CURVE 4 | CURVE 5 |
|-------------------|-------------------|
| P.I. = 16+91.92 | P.I. = 18+78.65 |
| Δ = 45°04'45" | Δ = 12°28'17" |
| D = 32°00'00" | D = 8°00'00" |
| T = 74.31' | T = 78.25' |
| L = 140.87' | L = 155.89' |
| R = 179.05' | R = 716.20' |
| e = 0.060 | e = 0.043 |
| P.I. N 23830.2093 | P.I. N 24008.4169 |
| E 23857.7613 | E 23779.9139 |

- GENERAL NOTES**
- ALL ITEMS NECESSARY FOR COMPLIANCE WITH THESE REQUIREMENTS SHALL BE INCLUDED IN THE PRICE BID FOR THE SPECIFIC ITEM.
 - ALL SIGNS & PAVEMENT MARKINGS SHALL CONFORM TO THE MANUAL ON UNIFORM TRAFFIC CONTROL DEVICES, (LATEST EDITION) AND ANY APPLICABLE FORSYTH COUNTY STANDARDS.
 - RAISED PAVEMENT MARKERS (RPM'S) SHALL BE INSTALLED ON BUFORD DAM ROAD.
 - ALL PAVEMENT MARKINGS SHALL BE THERMOPLASTIC UNLESS NOTED OTHERWISE.
 - ALL REGULATORY RED SERIES SIGNS SHALL BE CONSTRUCTED WITH TYPE VI-WIDE ANGLE PRISMATIC SIGN SHEETING.
 - ALL WARNING SIGNS SHALL BE CONSTRUCTED WITH TYPE VI-WIDE ANGLE PRISMATIC SIGN SHEETING. IN ADDITION, ALL SIGNS SHALL BE CONSTRUCTED USING FEDERALLY DESIGNATED FLORESCENT YELLOW COLOR.
 - ALL OTHER SIGNS FOR THIS PROJECT SHALL BE CONSTRUCTED WITH TYPE III-HIGH INTENSITY SIGN SHEETING.
 - ALL CROSS ROAD, SIDE ROAD & SIGNAL AHEAD SIGNS SHALL HAVE ADVISORY NAME BLADES INSTALLED ABOVE THE DIAMOND SHAPED SIGNS, ADVISING MOTORISTS OF THE NAME OF THE APPROACHING CROSS OR SIDE STREET. THE ADVISORY NAME BLADES SHALL BE 6" BY 24"-36", BLACK ON YELLOW, WITH 4" LETTERING. AT LOCATIONS WHERE CROSS STREETS CHANGE NAMES ARROWS SHALL BE PROVIDED ON THE ADVISORY BLADES IN ORDER TO INDICATE THE CORRECT STREET NAME.

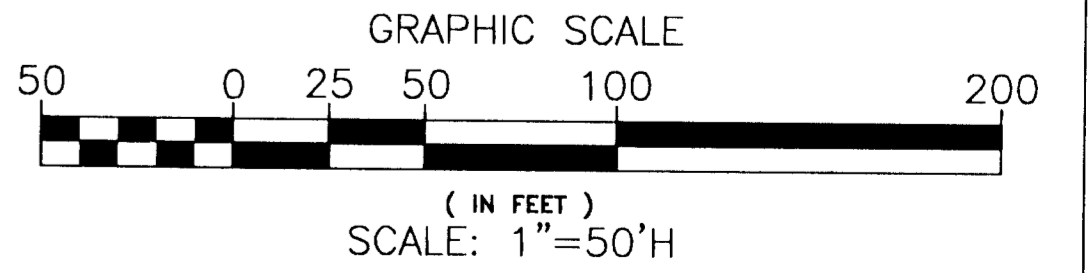

| REVISIONS | | | | | |
|-----------|----|-------------|------|----|-------------|
| DATE | BY | DESCRIPTION | DATE | BY | DESCRIPTION |
| | | | | | |

PRECISION PLANNING, INC.
 PLANNERS, ENGINEERS, ARCHITECTS & SURVEYORS
 400 PIKE BOULEVARD P.O. BOX 2210
 LAWRENCEVILLE, GEORGIA 30046
 (770) 338-8000

| DESIGNED BY | NAME | DATE | DRAWN BY | NAME | DATE |
|---------------|------|----------|------------|------|----------|
| AH | | 10/22/01 | KMM | | 09/27/01 |
| CHECKED BY | | | CHECKED BY | | |
| SUPERVISED BY | | | | | |

FORSYTH COUNTY BOARD OF COMMISSIONERS
 APPROVED BY: _____ DATE: _____

FORSYTH COUNTY INTERSECTION IMPROVEMENTS
SIGNING & STRIPING PLAN
 BUFORD DAM ROAD AT SAMPLES ROAD/LANIER BEACH SOUTH

DRAWING NUMBER: **5A-01**